

SV25 SHUTTLE VALVE

1/4" UP TO 690 BAR 10,000 PSI

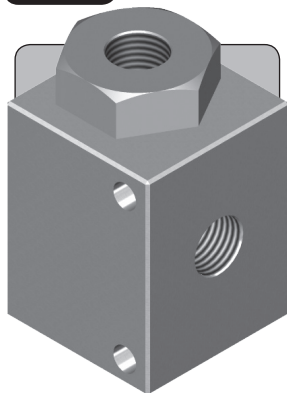

The SV25 is a 1/4" ported shuttle valve. The valve will sense the higher of two pressures and send this pressure to the outlet. The valve is often used to provide redundancy on pilot systems. In the event of pressure loss on one inlet, the valve will automatically switch to the higher pressure supply.

The valve includes a stainless steel and ceramic seating design to provide a robust low leakage solution.

- Shuttle valve
- Stainless steel construction
- Suitable for use subsea
- Compact design
- Ideal for combining dual redundant pilot supplies
- Suitable for use with mineral oils, water glycols, plain water and sea water
- Suitable for many other media. Contact us for advice
- NACE MR01-75 compliant materials
- Various seal options available
- Various porting options available

Specifications

BASIC MODEL NUMBER

SV25

SYMBOL

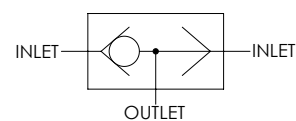

MAX WORKING PRESSURE

690 bar
(10,000 psi)

CV (FLOW CAPACITY)

0.33

FLUID

Liquids only
See materials section

TEMPERATURE RANGE

See Product Selector opposite
and Technical Data section

PORT SIZE

1/4"

WEIGHT

0.6 kg
(1.3 lb)

Specifications may change without notice

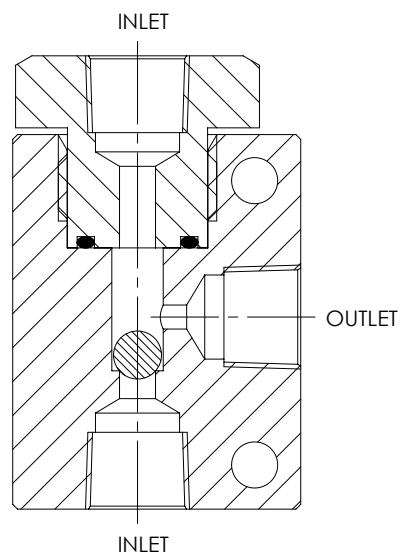

Materials

Externally Exposed Parts: 316 Stainless Steel.

Internally Wetted Parts: 316 Stainless Steel and Silicon Nitride ball.

The standard valve is designed for use with mineral oils, water glycols, plain water, sea water and may also be used with a wide variety of media compatible with the materials of construction.

! The standard valve has Viton® seals. Further seal options are available via the Product Selector. Compatibility with the working fluid at the operating temperature must be considered.

Typical Performance

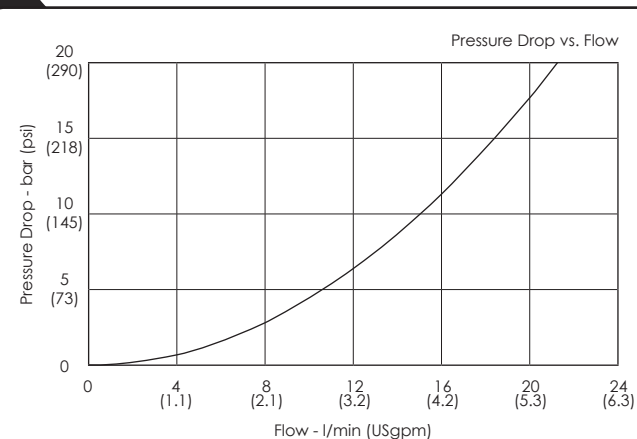

Typical performance based on water

Installation Diagram

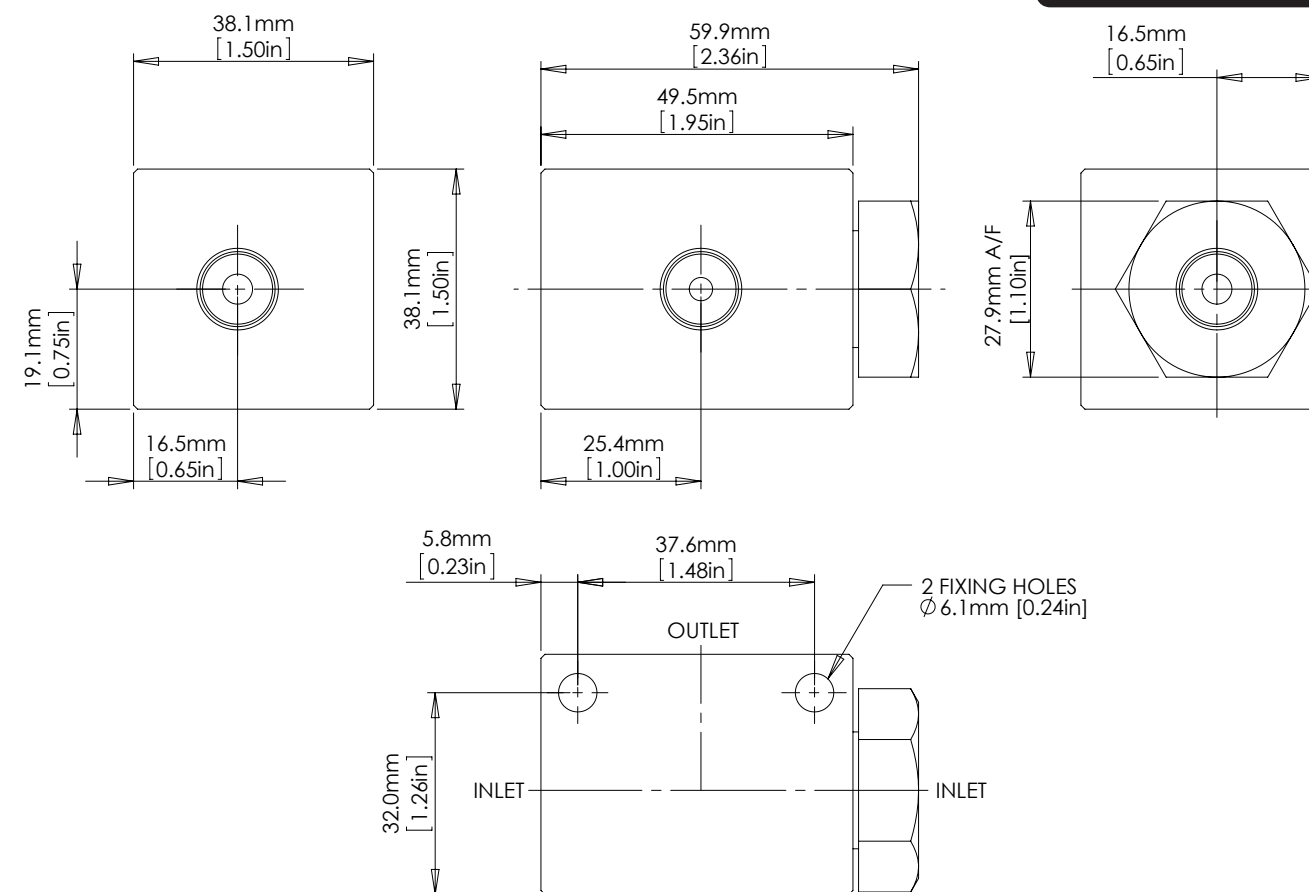

Product Selector

SV25 P - NBR - 10K

VALVE TYPE	PORTING OPTIONS	SEAL OPTIONS	MAX WORKING PRESSURE
SV25	<p>P 1/4" BSPP female</p> <p>N 1/4" NPT female</p>	<p>Leave blank for Viton® seals -10°C to +160°C</p> <p>NBR Nitrile seals -30°C to +105°C</p> <p>EP EPDM seals -45°C to +150°C</p> <p>KLZ Kalrez® seals -25°C to +200°C</p> <p>HNBR Hydrogenated Nitrile seals -20°C to +150°C</p> <p>Further seal options are available on request</p>	<p>10K 690 bar (10,000 psi) Liquid</p>

Repair and seal kits are available on request
For a seal kit add SK at the end of the model code and for a repair kit add RK



SOLENOID
STOP AND METERING
3 PORT DIRECTIONAL CONTROL
4 PORT DIRECTIONAL CONTROL
CHECK AND SHUTTLE
PILOT OPERATED CHECK
RELIEF
EXCESS FLOW
FILTERS
PRESSURE SENSING
PUMPS
ACTUATORS
TECHNICAL DATA